

Block 59

404 S State Route 59 | Naperville, IL 60540

DuPage Chicago-Naperville-Elgin, IL-IN 113,280 Sq Ft

41.7642, -88.2042

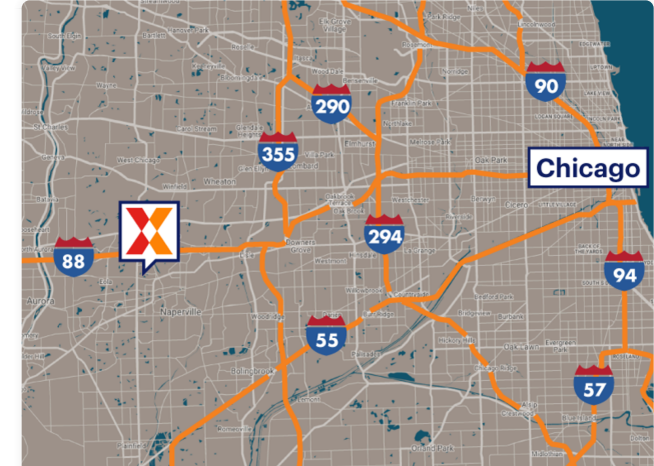
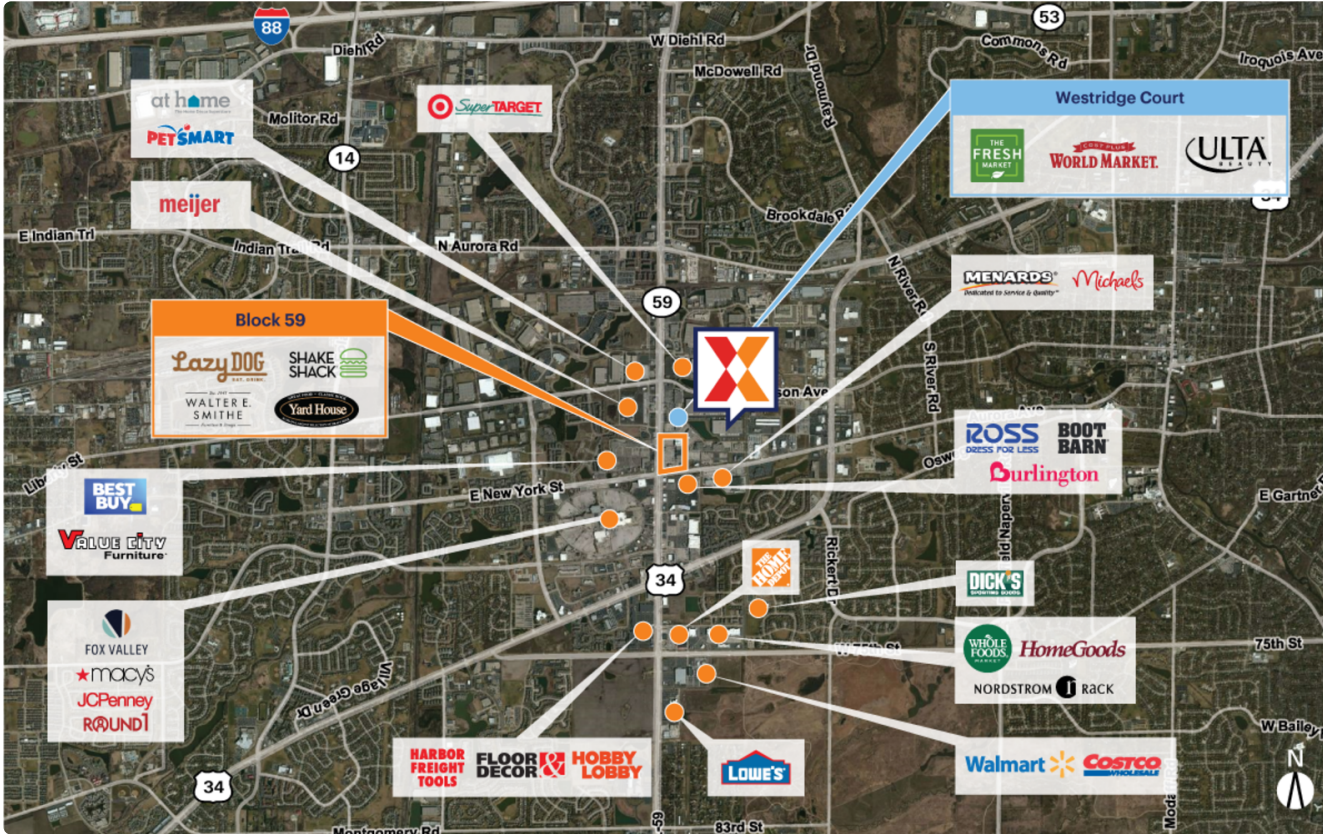

Demographics	1 Mile	3 Miles	5 Miles
Population	7,667	88,907	252,337
Daytime Pop.	14,607	123,310	297,317
Households	3,079	33,877	89,965
Income	\$136,415	\$152,629	\$157,755

Source: Synergos Technologies, Inc. 2024

Block 59 is a vibrant dining and entertainment district undergoing a \$53M center redevelopment, set for completion in 2026 and located adjacent to Brixmor's Westridge Court

Featuring architecture-rich details, and focusing on polished design highlighted by public gathering spaces and an event plaza

Featuring top restaurant brands: The Cheesecake Factory, Yard House, Velvet Taco, Shake Shack, Ruth's Chris Steak House, Lazy Dog Restaurants, Piccolo Buco, First Watch, CRISP & GREEN & Stan's Donuts & Coffee

Surrounded by a highly affluent, educated and dense population of 92K+, with average household incomes of \$167K+, and 64% holding a college degree within 3 miles

Excellent visibility from 50K+ vehicles daily on IL-59, 12K+ on W Jefferson Ave and 21K+ on Aurora Ave (Kalibrate 2025)

Prime location in 6M+ Sq Ft Naperville retail trade area



Block 59

404 S State Route 59 | Naperville, IL 60540

DuPage Chicago-Naperville-Elgin, IL-IN 113,280 Sq Ft

41.7642, -88.2042

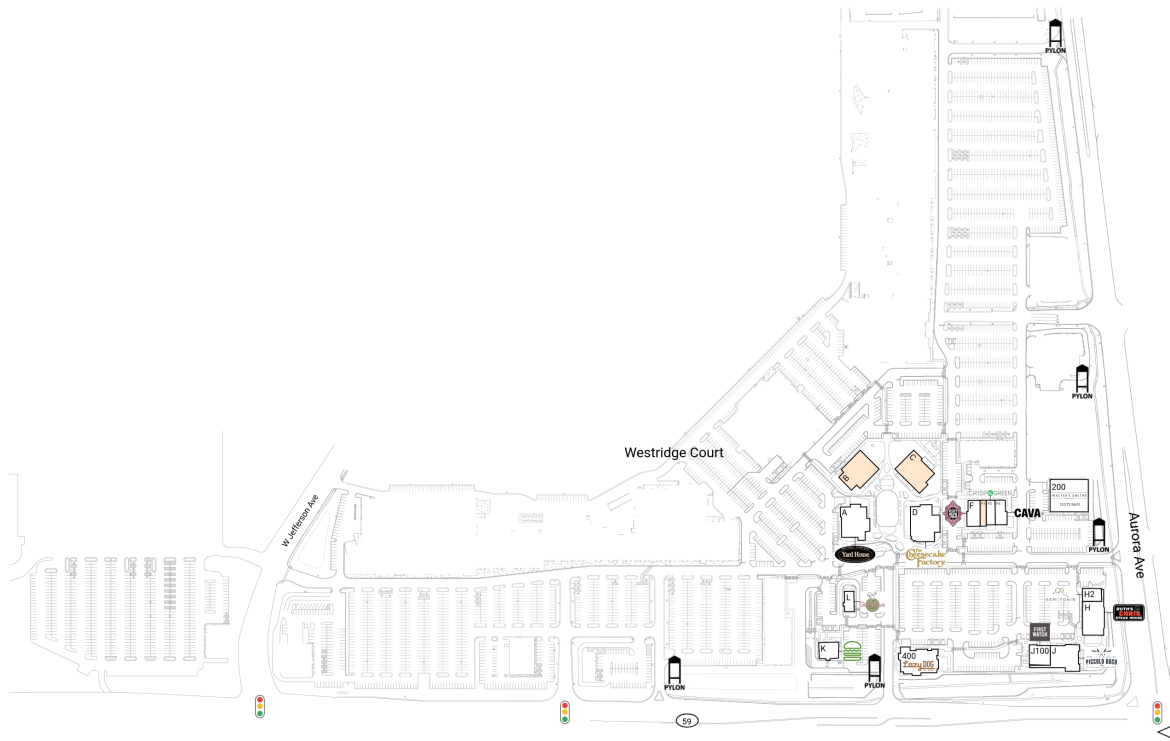

Available Spaces

B	11,000 Sq Ft	F1	1,600 Sq Ft
C	11,000 Sq Ft		

Current Tenants

Space size listed in square feet

200	Walter E. Smithe Furniture	12,272
400	Lazy Dog Cafe	8,213
A	Yard House	7,685
B	Benihana	7,200
B-2	The Perfect Manhattan	3,480
C2	Nan Xiang Xiao Long Bao	6,000
D	The Cheesecake Factory	9,700
F	Velvet Taco	3,400
F2	Crisp & Green	2,200
F3	Cava	2,800
H	Ruth's Chris Steak House	7,500
H2	Serotonin Centers	2,389
J	Piccolo Buco	7,493
J100	First Watch	4,048
K	Shake Shack	3,300
L	Stan's Donuts	2,000

This site plan is for illustrative and information purposes only, showing the general layout of the shopping center; and is not a legal survey. Brixmor makes no representation or warranty that the shopping center is exactly as depicted as site conditions and tenant mix are subject to change over time. 4158M

